

DIMENSION TABLE (MODEL WITHOUT BRAKE)

MODEL	LL	LR	LS	S	LW	WK	W	T	RH	TP
ECMA-M $\square$ 1309CS	163.5				---	---	---	---	---	M6, Depth 20
ECMA-M $\square$ 1309ES					36	8	8	7	18	---
ECMA-M $\square$ 1309PS					36	8	8	7	18	M6, Depth 20
ECMA-M $\square$ 1309RS					36	8	8	7	18	---
ECMA-K $\square$ 1310CS	147.5				---	---	---	---	---	M6, Depth 20
ECMA-K $\square$ 1310ES					36	8	8	7	18	---
ECMA-K $\square$ 1310PS					36	8	8	7	18	M6, Depth 20
ECMA-K $\square$ 1310RS					36	8	8	7	18	---
ECMA-K $\square$ 1315CS	167.5	55	47	22	---	---	---	---	---	M6, Depth 20
ECMA-K $\square$ 1315ES					36	8	8	7	18	---
ECMA-K $\square$ 1315PS					36	8	8	7	18	M6, Depth 20
ECMA-K $\square$ 1315RS					36	8	8	7	18	---
ECMA-K $\square$ 1320CS	187.5				---	---	---	---	---	M6, Depth 20
ECMA-K $\square$ 1320ES					36	8	8	7	18	---
ECMA-K $\square$ 1320PS					36	8	8	7	18	M6, Depth 20
ECMA-K $\square$ 1320RS					36	8	8	7	18	---
ECMA-J $\square$ 1330C4	187.5	55	47	24	---	---	---	---	---	M6, Depth 20
ECMA-J $\square$ 1330E4					36	8	8	7	20	---
ECMA-J $\square$ 1330P4					36	8	8	7	20	M6, Depth 20
ECMA-J $\square$ 1330R4					36	8	8	7	20	---

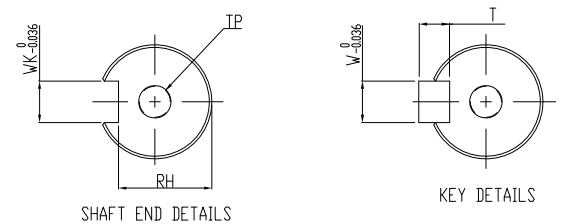

REV. ECN NO.

<b>台達電子工業股份有限公司</b> <b>DELTA ELECTRONICS, INC.</b>		DRAWN:	DESIGN:
THESE DRAWINGS AND SPECIFICATIONS ARE THE PROPERTY OF DELTA ELECTRONICS, INC. AND SHALL NOT BE REPRODUCED OR USED AS THE BASIS FOR THE MANUFACTURE OR SELL OF APPARATUS OR DEVICES WITHOUT PERMISSION.		APPROVE:	DATE: 06/14/2017
DIMENSIONAL TOLERANCES ( ) ( ) ( ) ( ) ANGLES DECIMALS <math>< 50</math> $\pm 0.1$ $< 50</math> \pm 0.15 < 50</math> \pm 0.2 < 30^{\circ}</math> \pm 0.1^{\circ}         X \pm 0.3 > 50-100 \pm 0.15 > 50-100 \pm 0.2 > 50-100 \pm 0.25 > 30^{\circ}-60^{\circ} \pm 0.3^{\circ}         X.X \pm 0.2 > 100-200 \pm 0.2 > 100-200 \pm 0.25 > 100-200 \pm 0.3 > 60^{\circ}-90^{\circ} \pm 0.5^{\circ}         X.XX \pm 0.1 > 200- <math>\pm 0.2</math> > 200- <math>\pm 0.25</math> > 200- <math>\pm 0.3</math>       $		DESCRIPTION: CONFIDENTIAL MOTOR_F130_380V	
USED ON	UNIT	SCALE	SHEET 1 OF 1
PART NO.: 		REV.:	01